

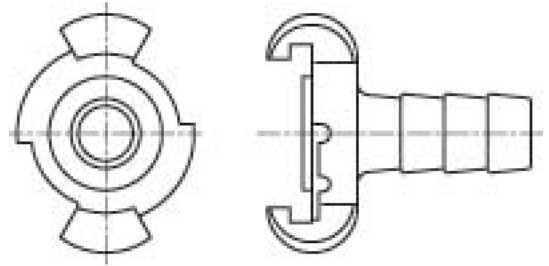

5001-21

CLAW COUPLING AIR - HOSE, STAINLESS STEEL



SPECIFICATIONS

Material	Stainless steel	Shape	Straight
Standard	DIN 3489	Connection 1 - Sealing	Gasket

DESCRIPTION

The Claw fitting air is a stainless steel coupling designed according to DIN 3489 standards. It features a straight shape with a 42mm claw fitting on one end and a hose fitting on the other, sealed with a gasket for secure connections. This durable coupling from the Claw family ensures reliable performance in demanding air hose applications.

Item number	Type 1	Size 1	Type 2	Size 2	Size 2	Wp
50012106	Claw fitting 42mm	Claw 42	Hose Fitting	3/8"	10 mm	1 MPa
50012108	Claw fitting 42mm	Claw 42	Hose Fitting	1/2"	13 mm	1 MPa
50012112	Claw fitting 42mm	Claw 42	Hose Fitting	3/4"	19 mm	1 MPa
50012116	Claw fitting 42mm	Claw 42	Hose Fitting	1"	25 mm	1 MPa