

5001-22

CLAW COUPLING AIR - BSP MALE, STAINLESS STEEL

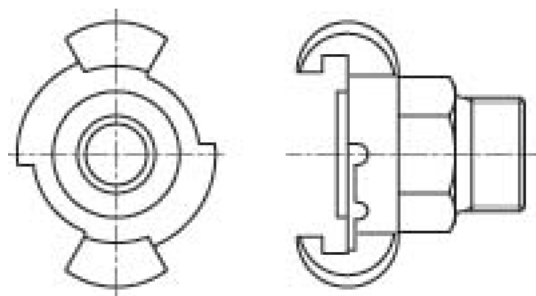

SPECIFICATIONS

Material	Stainless steel	Shape	Straight
Standard	DIN 3489	Connection 1 - Sealing	Gasket

DESCRIPTION

The Claw fitting air - BSP male, Stainless steel is a straight-shaped coupling from the Coupling - Claw family, designed according to DIN 3489 standards. It features a 42mm claw fitting with gasket sealing on one end and a male BSP G-thread connection on the other. Made from durable stainless steel, this coupling ensures reliable performance and corrosion resistance.

Item number	Type 1	Size 1	Type 2	Thread type 2	Size 2	Type 2	Wp
50012206	Claw fitting 42mm	Claw 42	Thread	G	3/8"	Male	1 MPa
50012208	Claw fitting 42mm	Claw 42	Thread	G	1/2"	Male	1 MPa
50012212	Claw fitting 42mm	Claw 42	Thread	G	3/4"	Male	1 MPa
50012216	Claw fitting 42mm	Claw 42	Thread	G	1"	Male	1 MPa