

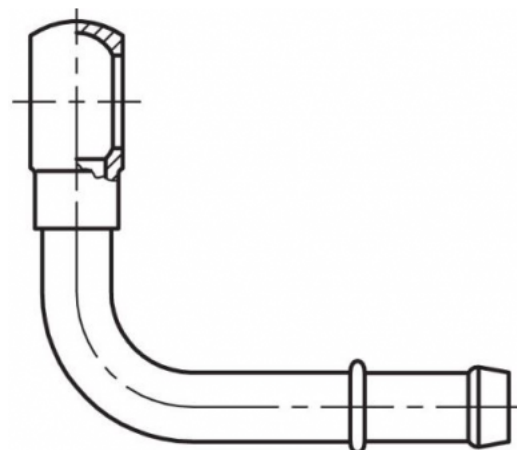

# 5882-xx

## HOSE FITTING BANJO 90° - HOSE, STEEL



### SPECIFICATIONS

<b>Material</b>	Steel	<b>Shape</b>	90°
-----------------	-------	--------------	-----

### DESCRIPTION

The Hose fitting Banjo 90° is a steel coupling designed for industrial applications. Featuring a 90° shape, it connects a banjo fitting to a hose, ensuring a secure and durable connection. Crafted from robust steel, this adapter provides reliable performance within the coupling and industrial adapter family.

Item number	Type 1	Size 1	Type 2	Size 2	Wp
58820803	Banjo	8x1	Hose Fitting	3	6.5 MPa
58821003	Banjo	10x1	Hose Fitting	3	6.5 MPa
58821004	Banjo	10x1	Hose Fitting	4	6.5 MPa
58821206	Banjo	12x1,5	Hose Fitting	6	5.5 MPa
58821408	Banjo	14x1,5	Hose Fitting	8	5 MPa
58821610	Banjo	16x1,5	Hose Fitting	10	5 MPa
58821813	Banjo	18x1,5	Hose Fitting	13	4 MPa
58822216	Banjo	22x1,5	Hose Fitting	16	3.5 MPa
58822620	Banjo	26x1,5	Hose Fitting	20	3.5 MPa